



www.larius.com

Cod. 150095

PLA Airless Gun

Professional extension
With Super Fast-Clean

Aluminium 250 BAR/MAX
Steel 450 BAR/MAX



INSTRUCTION MANUAL



IT https://www.larius.com/wp-content/uploads/PISTOLA_PLA_I.pdf

EN https://www.larius.com/wp-content/uploads/PISTOLA_PLA_GB.pdf

This manual is to be considered as an English language translation of the original manual in Italian. The manufacturer shall bear no responsibility for any damages or inconveniences that may arise due to the incorrect translation of the instructions contained within the original manual in Italian.

Due to a constant product improvement programme, the factory reserves the right to modify technical details mentioned in this manual without prior notice.

PLA Airless Gun

Professional extension with Super Fast-Clean

INDEX



















A	WARNINGS	p. 4
B	SAFETY RULES.....	p. 5
C	DESCRIPTION.....	p. 7
D	INSTRUCTIONS OF USE	p. 8
E	MAINTENAINCE	p. 8
F	REPLACEMENT IF THE SEALS OF THE SPRAY GUN BODY	p. 9
G	SPARE PARTS.....	p.10
	Pla airless gun	p.10
	Kit	p.12
	Spare parts.....	p.12
	Nozzles super fast-clean	p.12
	Super fast-clean	p.13

**WE ADVISE THE USE OF THIS EQUIPMENT ONLY BY PROFESSIONAL OPERATORS.
ONLY USE THIS MACHINE FOR USAGE SPECIFICALLY MENTIONED IN THIS MANUAL.**

Thank you for choosing a **SAMOA** product.
As well as the product purchased, you will receive a range of support services
enabling you to achieve the results desired, quickly and professionally.

A WARNINGS

The table below provides the meaning of the symbols used in this manual in relation to using, earthing, operating, maintaining, and repairing of this equipment.

	<ul style="list-style-type: none"> • Read this operator's manual carefully before using the equipment. • An improper use of this machine can cause injuries to people or things. • Do not use this machine when under the influence of drugs or alcohol. • Do not modify the equipment under any circumstances. • Use products and solvents that are compatible with the various parts of the equipment, and read the manufacturer's warnings carefully. • See the Technical Details for the equipment given in the Manual. • Check the equipment for worn parts once a day. If any worn parts are found, replace them using ONLY original spare parts. • Keep children and animals away from work area. • Comply with all safety standards.
	<ul style="list-style-type: none"> • It indicates an accident risk or serious damage to equipment if this warning is not followed.
   	<p>FIRE AND EXPLOSION HAZARD</p> <ul style="list-style-type: none"> • Solvent and paint fumes in work area can ignite or explode. • To help prevent fire and explosion: <ul style="list-style-type: none"> - Use equipment ONLY in well ventilated area. - Eliminate all ignition sources, such as pilot lights, cigarettes and plastic drop cloths (potential static arc). - Ground equipment and conductive objects. - Use only grounded hoses. - Do not use trichloroethane, methylene chloride, other halogenated hydrocarbon solvents or fluids containing such solvents in pressurized aluminium equipment. Such use can cause serious chemical reaction and equipment rupture, and result in death, serious injury, and property damage. - Do not form connections or switch light switches on or off if the air contains inflammable fumes. • If electrical shocks or discharges are encountered the operation being carried out using the equipment must be stopped immediately. • Keep a fire extinguisher at hand in the immediate vicinity of the work area.
	<ul style="list-style-type: none"> • It indicates wound and finger squashing risk due to movable parts in the equipment. • Tenersi lontano dalle parti in movimento. • Do not use the equipment without the proper protection. • Before any inspection or maintenance of the equipment, carry out the decompression procedure explained in this manual, and prevent any risk of the equipment starting unexpectedly.
 	<ul style="list-style-type: none"> • Report any risk of chemical reaction or explosion if this warning has not been given. • (IF PROVIDED) There is a risk of injury or serious lesion related to contact with the jet from the spray gun. If this should occur, IMMEDIATELY contact a doctor, indicating the type of product injected. • (IF PROVIDED) Do not spray before the guard has been placed over the nozzle and the trigger on the spray gun. • (IF PROVIDED) Do not put your fingers in the spray gun nozzle. • Once work has been completed, before carrying out any maintenance, complete the decompression procedure.
	<ul style="list-style-type: none"> • It indicates important recommendations about disposal and recycling process of products in accordance with the environmental regulations.
    	<ul style="list-style-type: none"> • Mark any clamps attached to earth cables. • Use ONLY 3-wire extension cords and grounded electrical outlets. • Before starting work make sure that the electrical system is grounded and that it complies with safety standards. • High-pressure fluid from gun, hose leaks, or ruptured components will pierce skin. • To help prevent injection, always: <ul style="list-style-type: none"> - (IF PROVIDED) Engage trigger lock when not spraying. - (IF PROVIDED) Do not put your hand over the spray tip. Do not stop or deflect leaks with your hand, body or other. - (IF PROVIDED) Do not point gun at anyone or at any part of the body. - (IF PROVIDED) Never spray without tip guard. - Do pressure relief if you stop spraying or being servicing sprayer and before any maintenance operations. - Do not use components rated less than sprayer Maximum Working Pressure. - Never allow children to use this unit - (IF PROVIDED) Brace yourself; gun may recoil when triggered. • If high pressure fluid pierces your skin, the injury might look like "just a cut", but it is a serious wound! Get immediate medical attention.
   	<ul style="list-style-type: none"> • It is obligatory to wear suitable clothing as gloves, goggles and face shield. • Wear clothing that complies with the safety standards in force in the country in which the equipment is used. • Do not wear bracelets, earrings, rings, chains, or anything else that may hinder the operator's work. • Do not wear clothing with wide sleeves, scarves, ties, or any other piece of clothing that could get tangled up in moving parts of the equipment during the work, inspection, or maintenance cycles.

B SAFETY RULES



Read carefully and entirely the following instructions before using the product.

Please save these instructions in a safe place.

The unauthorised tampering/replacement of one or more parts composing the machine, the use of accessories, tools, expendable materials other than those recommended by the manufacturer can be a danger of accident.

The manufacturer will be relieved from tort and criminal liability.

- ALWAYS DISCONNECT THE SUPPLY AND RELEASE THE PRESSURE IN THE CIRCUIT BEFORE PERFORMING ANY CHECK OR PART REPLACEMENT OF THE EQUIPMENT.
- NEVER MODIFY ANY PART IN THE EQUIPMENT. CHECK REGULARLY THE COMPONENTS OF THE SYSTEM. REPLACE THE PARTS DAMAGED OR WORN.
- TIGHTEN AND CHECK ALL THE FITTINGS FOR CONNECTION BETWEEN PUMP, FLEXIBLE HOSE AND SPRAY GUN BEFORE USING THE EQUIPMENT.
- ALWAYS USE THE FLEXIBLE HOSE SUPPLIED WITH STANDARD KIT. THE USE OF ANY ACCESSORIES OR TOOLING OTHER THAN THOSE RECOMMENDED IN THIS MANUAL, MAY CAUSE DAMAGE OR INJURE THE OPERATOR.
- THE FLUID CONTAINED IN THE FLEXIBLE HOSE CAN BE VERY DANGEROUS. HANDLE THE FLEXIBLE HOSE CAREFULLY. DO NOT PULL THE FLEXIBLE HOSE TO MOVE THE EQUIPMENT. NEVER USE A DAMAGED OR A REPAIRED FLEXIBLE HOSE.
- THE EMPLOYER SHALL TRAIN ITS EMPLOYEES ABOUT ALL THOSE RISKS STEMMING FROM ACCIDENTS, ABOUT THE USE OF SAFETY DEVICES FOR THEIR OWN SAFETY AND ABOUT THE GENERAL RULES FOR ACCIDENT PREVENTION IN COMPLIANCE WITH INTERNATIONAL REGULATIONS AND WITH THE LAWS OF THE COUNTRY WHERE THE PLANT IS USED.
- THE BEHAVIOUR OF THE EMPLOYEES SHALL STRICTLY COMPLY WITH THE ACCIDENT PREVENTION AND ALSO ENVIRONMENTAL REGULATIONS IN FORCE IN THE COUNTRY WHERE THE PLANT IS INSTALLED AND USED.
- KEEP YOUR WORK PLACE CLEAN AND TIDY. DISORDER WHERE YOU ARE WORKING CREATES A POTENTIAL RISK OF ACCIDENTS.
- ALWAYS KEEP PROPER BALANCE AVOIDING UNUSUAL STANCE.
- BEFORE USING THE TOOL, ENSURE THERE ARE NOT DAMAGED PARTS AND THE MACHINE CAN WORK PROPERLY.
- ALWAYS FOLLOW THE INSTRUCTIONS ABOUT SAFETY AND THE REGULATIONS IN FORCE.
- KEEP THOSE WHO ARE NOT RESPONSIBLE FOR THE EQUIPMENT OUT OF THE WORK AREA.
- NEVER EXCEED THE MAXIMUM WORKING PRESSURE INDICATED.
- NEVER POINT THE SPRAY GUN AT YOURSELVES OR AT OTHER PEOPLE. THE CONTACT WITH THE CASTING CAN CAUSE SERIOUS INJURIES. IN CASE OF INJURIES CAUSED BY THE GUN CASTING, SEEK IMMEDIATE MEDICAL ADVICE SPECIFYING THE TYPE OF THE PRODUCT INJECTED. NEVER UNDERVALUE A WOUND CAUSED BY THE INJECTION OF A FLUID.



The high speed of the product flowing in the hose can create static electricity through discharges and sparks. It is suggested to earth the equipment. The pump is earthed through the earth cable of the supply.

The gun is earthed through the high pressure flexible hose.

All the conductors near the work area must be earthed.

- NEVER SPRAY OVER FLAMMABLE PRODUCTS OR SOLVENTS IN CLOSED PLACES.
- NEVER USE THE TOOLING IN PRESENCE OF POTENTIALLY EXPLOSIVE GAS.



Always check the product is compatible with the materials composing the equipment (*pump, spray gun, flexible hose and accessories*) with which it can come into contact. Never use paints or solvents containing halogen hydrocarbons (as the *methylene chloride*).

If these products come into contact with aluminium parts can provoke dangerous chemical reactions with risk of corrosion and explosion.



If the product to be used is toxic, avoid inhalation and contact by using protection gloves, goggles and proper face shields.



Take proper safety measures for the protection of hearing in case of work near the plant.

- WHENEVER YOU STOP DISPENSING, EVEN FOR A MOMENT, ALWAYS SET THE GUN TRIGGER LOCK. FULLY RELEASE THE TRIGGER AND ROTATE THE TRIGGER LOCK FORWARD (SEE PAGE 12).
- PAY THE UTMOST ATTENTION WHEN CLEANING OR CHANGING THE FLUID NOZZLE. IF THE NOZZLE CLOGS WHILE DISPENSING, FULLY RELEASE THE TRIGGER IMMEDIATELY. ALWAYS FOLLOW THE PRESSURE RELIEF PROCEDURE, BELOW, BEFORE WIPING OFF BUILD-UP AROUND THE NOZZLE OR REMOVING THE NOZZLE TO CLEAN IT.



DO NOT DIRECT THE SPRAYGUN UPWARDS DURING CLEANING.



DO NOT RUB THE SPRAYGUN WITH CLOTHS SOAKED IN SOLVENT.



DO NOT IMMERSE THE SPRAYGUN IN SOLVENT.



DO NOT USE METAL TOOLS TO CLEAN THE NOZZLES, SINCE THEY MAY BE SCRATCHED AND CAUSE UNEVEN SPRAYING.

C DESCRIPTION

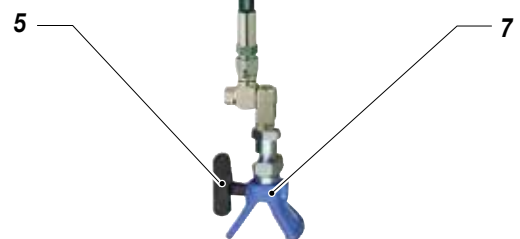
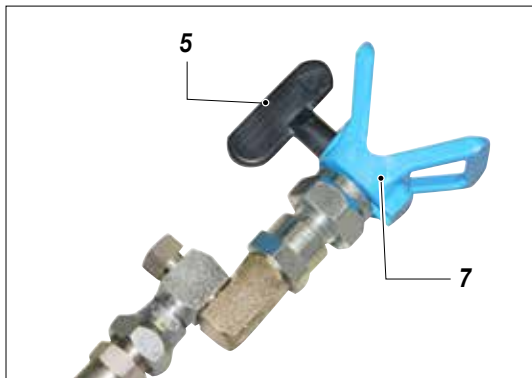
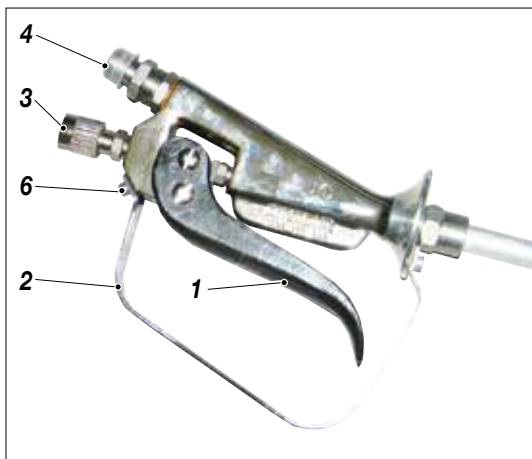
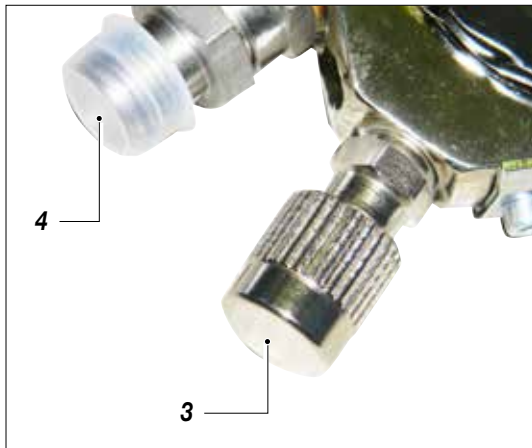

Pos.	Description
1	Trigger
2	Finger protection
3	Safety
4	Fitting for high pressure hose
5	Nozzle (see table)
6	Ground wire connection screw
7	Body super fast clean

D INSTRUCTIONS OF USE

Before connecting the spray gun to the pump, select the nozzle type, which fits to the kind of work you're beginning (see table).

SAFETY LOCK

Be sure that the trigger is locked, by rotating the safety lock (all spray guns are supplied by the manufacturer safety locked).

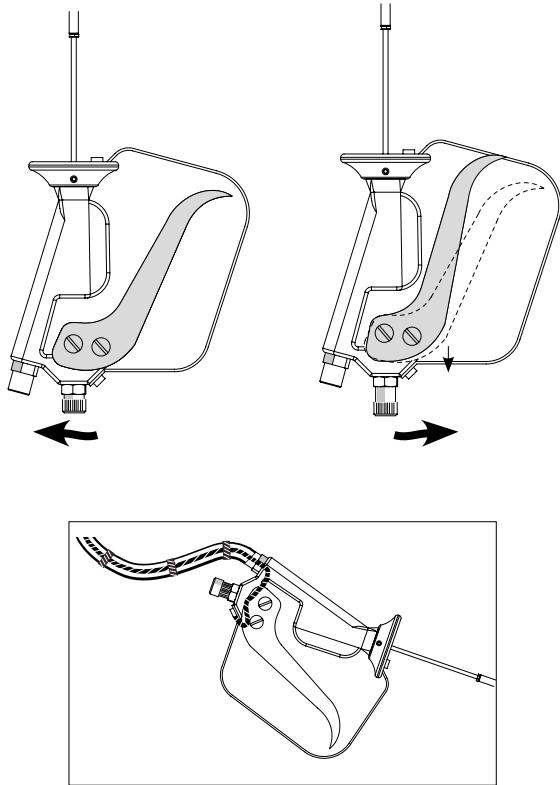

Make sure that the spray fan of the nozzle is in the correct position (horizontal or vertical), apt for the kind of work you're beginning.

Connect the high pressure hose to the spray gun. The correct installation should be done by using a hose having a grounding connection, otherwise it is possible to connect a grounding wire to the screw 31 and fix it all along the hose itself, by means of a tape or clamps.

Control that all the threaded fittings both of spray gun and of pump are perfectly tightened.

Keeping the safety lock inserted, set the spray gun under pressure and, keeping the nozzle far away from you or any other person, unlock the safety lock, press on the trigger and begin to spray.

In order to avoid accidents, whenever you must leave the spray gun unattended, lock the safety lock.

At the end of the work clean spray gun and pump with the solvent apt for the product, which is being used.

E MAINTENANCE

Before proceeding with any servicing, be sure that the spray gun has no pressure inside and that the product is finished.

PUNCH SETTING

For getting a correct working the punch (2) moved by the trigger (7) should open of roughly 3 mm. This setting must be done by acting on the nut (3) screwing or unscrewing the punch (2) in the sleeve (4) and locking then the nuts (3).

After having reassembled the pipe (1) on the spray gun, control that the distance between the nut (6) and the screw (5) is about one millimeter. This guarantees that the setting has been correctly done. During the setting, release the safety lock, in order to allow the movement of the rod.

LEAKS

If any leak of product should occur, it is sufficient to lock the screw (5) which has the function of a stuffing box.

REPLACEMENT OF THE PUNCH

Unscrew the pipe (1) of the spray gun. Take out the rod from the pipe and control the punch (2). In order to replace it, you need to unscrew it, after having loosened the nut (3). Proceed then to the setting, as described before. During the operations of disassembly and reassembly of the rod in the pipe, keep the trigger open (safety locked), in order to avoid damages to the rod, in the case that this latter forces on the ball seat in the sleeve.

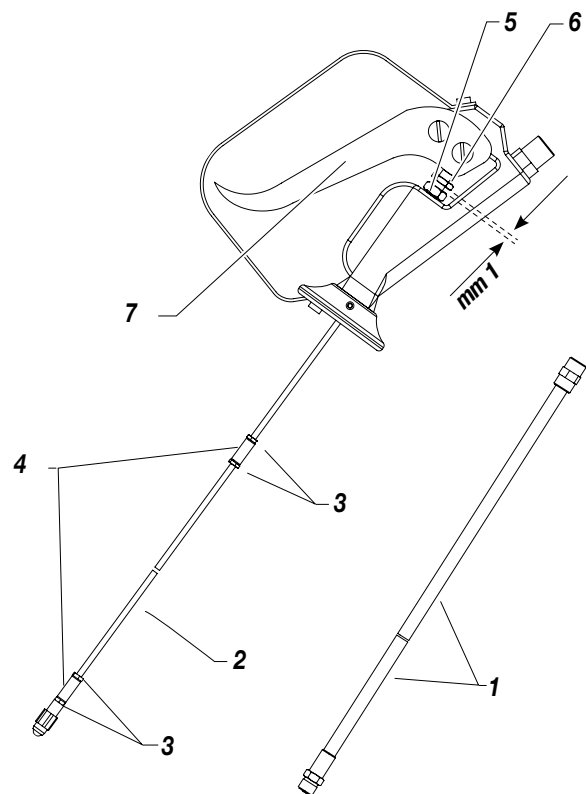

F REPLACEMENT OF THE SEALS OF THE SPRAY GUN BODY

- A) Take out the pipe (1)
- B) Remove the rod with the punch.
- C) Remove all the control part of the rod (trigger, guard, safety, etc.)
- D) A light pressure on the rod will allow the extraction of the seals (2)
- E) During the disassembly of the safety lock (5) it is necessary to unlock it completely (clockwise) and unscrew the complete part from the gun body.

Pay attention to the light residual pressure on the main spring (4), it is therefore advisable not to expose any part of your body near to it.

During the reassembly, make sure that the safety nut (5) is locked, in order to make the insertion and the assembly in the gun body easier.

A light pressure will be necessary to make this possible.

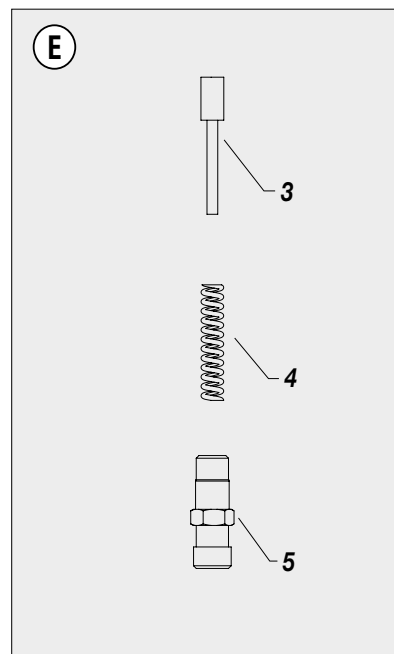
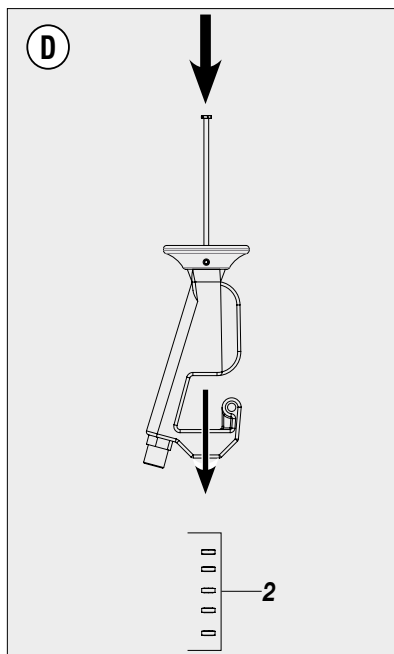
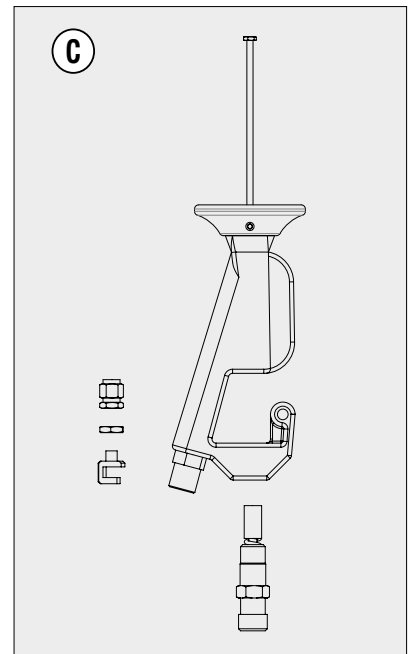
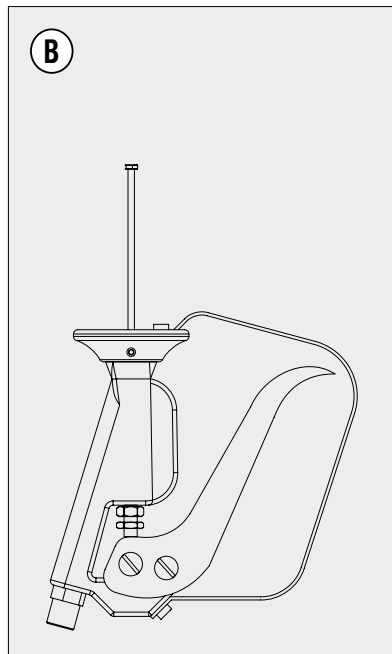
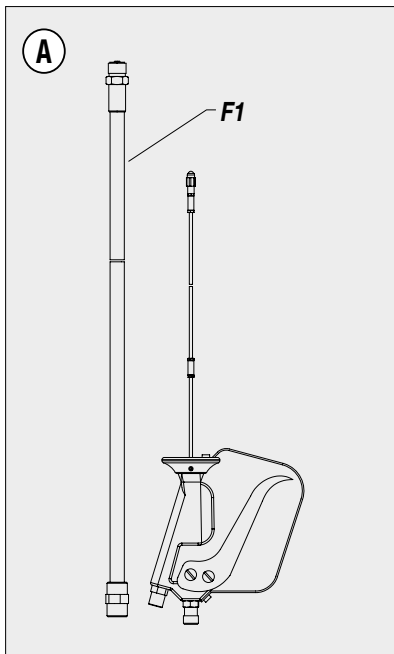

G SPARE PARTS

PLA AIRLESS GUN

WARNING: Always indicate code and quantity for each part required.

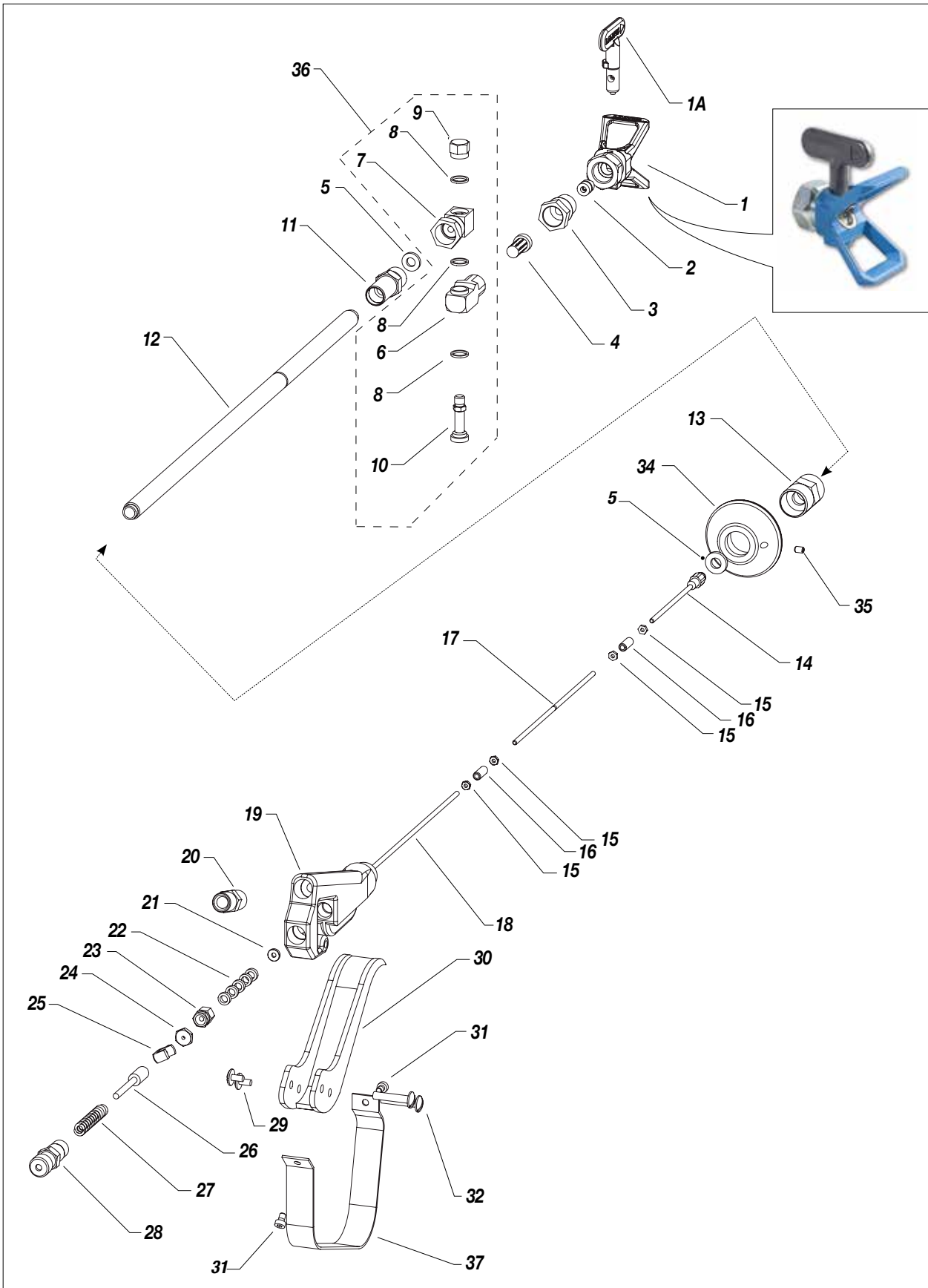

Pos.	Codice	Descrizione	Q.tà
1	18270	Body Super Fast Clean	1
1A	Tab.	Super fast clean	1
2	18280	Gasket Super Fast Clean	1
3	320	Joint adapter for SFC	1
4	271	Filter material	1
5	11003	Gasket	2
6	90006	Filter holder	1
7	90007	Revolving joint	1
8	90008	Nylon Gasket	3
9	90009	Locking nut	1
10	90010	Retaining pin	1
11	90042	Sleeve ball seat	1
12	90014	Tube pla cm 130 (aluminium, 250 bar/max)	1
	90047	Tube pla cm 130 (steel, 450 bar/max)	1
	90015	Tube pla cm 180 (aluminium, 250 bar/max)	1
	90048	Tube pla cm 180 (steel, 450 bar/max)	1
	90016	Tube pla cm 240 (aluminium, 250 bar/max)	1
	90049	Tube pla cm 240 (steel, 450 bar/max)	1
13	90043	Articulated	1
14	11005	Punch	1
15	90025	Nut M3 steel	4
16	90021	Bush	2
17	90022	Extension punch pla cm 130	1
	90023	Extension punch pla cm 180	1
	90024	Extension punch pla cm 240	1

Pos.	Codice	Descrizione	Q.tà
18	90026	Rod for Handgrip	1
19	90027	Handgrip	1
	90027/1	Handgrip hight presssure STEEL	1
20	10159	Revolving joint M16x1,5	1
	10156	revolving joint 1/4"	1
21	90031	Supports seal ring	1
22	90032	Gasket	5
23	90033	Locking nut	1
24	90034	Nut	1
25	90035	Guide	1
26	90028	Spring guide pin	1
27	90029	Spring	1
28	90030	Adjustment ring	1
29	90036	Screw Trigger	2
30	90037	Trigger	1
31	96025	Screw cuff M4x6	2
32	17514	Trigger pin	2
33	90040	Safety for hand	1
34	90017	Ring handgrip	1
35	90018	Wheat M4x6	1
36	90050	Articulated fully articulated	1
37	90040	Finger protection	1

KIT PLA AIRLESS GUN COMPLETE							
Code	Piston rod length	Aluminium	Steel	Revolving joint		Base Super Fast-Clean	Filter material + joint adapter
				M16x1,5	1/4"		
K11421	130 cm	√		√		√	√
K11420	130 cm	√			√	√	√
K11426	180 cm	√		√		√	√
K11425	180 cm	√			√	√	√
K11431	240 cm	√		√		√	√
K11430	240 cm	√			√	√	√
K11435	130 cm		√	√		√	√
K11436	130 cm		√		√	√	√
K11440	180 cm		√	√		√	√
K11441	180 cm		√		√	√	√
K11445	240 cm		√	√		√	√
K11446	240 cm		√		√	√	√



- NEVER place your hand or fingers in front on of the nozzle, NEVER point the gun at yourself or anyone else
- Discharge the pressure in the gun and use the appropriate safety precautions when the operator is not working
- DO NOT cut or tamper with the safety mechanisms on the device.

KIT

Code	Description
40225	Kit PLA airless gun seals
40220	Kit airless gun PLA
40394	Kit series pre-filter mesh nozzle

SPARE PARTS

Code	Description
90050	Swivel
270	Filter 100 mesh
271	Filter 60 mesh

NOZZLES SUPER FAST CLEAN

Compatible with all Airless
 Nozzles SUPER FAST CLEAN + 1 Stainless steel seal Code 18280
 From size 7-20 to 51-80



see table

Size	Flow L/M200 BAR	Size	Flow L/M200 BAR
SFC 7-20	* 0,26	SFC 15-60	* 1,10
SFC 7-40	* 0,26	SFC 17-20	* 1,41
SFC 9-20	* 0,35	SFC 17-40	* 1,41
SFC 9-40	* 0,35	SFC 17-60	* 1,41
SFC 11-20	* 0,55	SFC 19-20	* 1,77
SFC 11-40	* 0,55	SFC 19-40	* 1,77
SFC 13-20	* 0,80	SFC 19-60	* 1,77
SFC 13-40	* 0,80	SFC 21-20	* 2,15
SFC 13-60	* 0,80	SFC 21-40	* 2,15
SFC 15-20	* 0,80	SFC 21-60	* 2,15
SFC 15-40	* 1,10	SFC 23-20	* 2,57

Size	Flow L/M200 BAR	Size	Flow L/M200 BAR	Size	Flow L/M200 BAR
SFC 23-40	* 2,57	SFC 29-60	* 4,30	SFC 39-60	* 7,10
SFC 23-60	* 2,57	SFC 29-80	* 4,30	SFC 39-80	* 7,10
SFC 25-20	* 2,90	SFC 31-40	* 4,83	SFC 41-40	* 8,10
SFC 25-40	* 2,90	SFC 31-60	* 4,83	SFC 43-40	* 9,67
SFC 25-60	* 2,90	SFC 31-80	* 4,83	SFC 43-60	* 9,67
SFC 27-20	* 3,50	SFC 33-40	* 5,50	SFC 43-80	* 9,67
SFC 27-40	* 3,50	SFC 33-60	* 5,50	SFC 45-60	* 9,80
SFC 27-60	* 3,50	SFC 33-80	* 5,50	SFC 47-60	* 10,70
SFC 27-80	* 3,50	SFC 35-40	* 6,00	SFC 51-40	* 12,70
SFC 29-20	* 4,30	SFC 37-40	* 6,70	SFC 51-60	* 12,20
SFC 29-40	* 4,30	SFC 39-40	* 7,10	SFC 51-80	* 12,20



BASE SUPER FAST CLEAN Art. 18270



NOZZLE SUPER FAST CLEAN Art. 18280 steel seal



SUPER FAST CLEAN COMPLETE from size 7-20



SUPER FAST-CLEAN

*Cod. nozzle-angle	Ø inch	Ø mm	Prod. type	Filter recom.
SFC07-20	0,007"	0,18	Clear and pigmented coats, thin enamels	Red 200 M
SFC07-40				
SFC09-20	0,009"	0,23	Nitro, synthetic and polyurethane paints	Yellow 100 M
SFC09-40				
SFC11-20	0,011"	0,28		
SFC11-40				
SFC13-20	0,013"	0,33		
SFC13-40				
SFC13-60				
SFC15-20	0,015"	0,38	Antitrust	
SFC15-40				
SFC15-60				
SFC17-20	0,017"	0,43		
SFC17-40				
SFC17-60				
SFC19-20	0,019"	0,48	Coatings, zinc inorganic water paints	
SFC19-40				
SFC19-60				
SFC21-20	0,021"	0,53		
SFC21-40				
SFC21-60				
SFC23-20	0,023"	0,58		
SFC23-40				
SFC23-60				
SFC25-20	0,025"	0,63		
SFC25-40				
SFC25-60				
SFC27-20	0,027"	0,68		White 60 M
SFC27-40				
SFC27-60				
SFC27-80				
SFC29-20	0,029"	0,74		
SFC29-40				
SFC29-60				
SFC29-80				
SFC31-40	0,031"	0,79	Thixotropic, stucco spray, high solids paints with glue, fillers	
SFC31-60				
SFC31-80	0,033"	0,83		
SFC33-40				
SFC33-60	0,035"	0,89		
SFC33-80				
SFC35-40	0,037"	0,94		
SFC37-40				
SFC39-40	0,039"	1,00		
SFC39-60				
SFC39-80				
SFC41-40	0,041"	1,05		
SFC43-40	0,043"	1,10		Green 30 M
SFC43-60				
SFC43-80				
SFC45-60	0,045"	0,15		
SFC47-60	0,047"	1,20		
SFC51-60	0,051"	1,30		
SFC51-80				



- Compatible with all Airless guns
- Rapid replacement of working nozzle
- Rapid safe cleaning
- Maximum working pressure 350 bar (5075 psi)
- Long lasting carbon-tungsten insert
- Excellent finish



**SAMOA INDUSTRIAL, S.A. - HEADQUARTERS
SPAIN AND EXPORT MARKETS**

POL. IND. PORCEYO, I-14 - CAMINO DEL FONTÁN, 831
E-33392 GIJÓN (ASTURIAS), SPAIN
TEL.: +34 985 381 488 - FAX: + 34 985 147 213

**SAMOA ITALIA - LARIUS
ITALY**

VIA ANTONIO STOPPANI,21
23801 CALOLZIOCORTE (LC) ITALY
Tel.: +39 0341 621152 - Fax: + 39 0341 621242

**SAMOA LTD.
UNITED KINGDOM AND REP. OF IRELAND**

ASTURIAS HOUSE - BARRS FOLD ROAD
WINGATES INDUSTRIAL PARK
WESTHOUGHTON, BL5 3XP, UK
TEL.: +44 1942 850600 - FAX: +44 1942 812160

**SAMOA S.A.R.L.
FRANCE**

P.A.E.I. DU GIESSEN
3, RUE DE BRISCHBACH
67750 SCHERWILLER, FRANCE
TEL.: +33 3 88 82 79 62 - FAX: +33 3 88 82 77 88

**SAMOA FLOWTECH GMBH
GERMANY, AUSTRIA, SWITZERLAND, THE NETHERLANDS AND GREECE**

AM OBEREICHHOLZ 4
D - 97828 MARKTHEIDENFELD, GERMANY
TEL.: +49 9391 9826 0 - FAX: +49 9391 98 26 50



SAMOA CORPORATION

USA AND CANADA
90 MONTICELLO ROAD
WEAVERVILLE, NC 28787, USA
TEL. +1 (828) 645-2290 - FAX: +1 (828) 658 0840



©Copyright, SAMOA INDUSTRIAL, S.A.
SAMOA Industrial, S.A. is an ISO 9001, ISO 14001 and ISO 45001 certified company.

»»» Contact us today!
Visit www.samoaindustrial.com for more information.

INSTRUCTION MANUAL AVAILABLE IN:		
	IT	https://www.larius.com/wp-content/uploads/PISTOLA_PLA_I.pdf
	EN	https://www.larius.com/wp-content/uploads/PISTOLA_PLA_GB.pdf