

# PG SERIES

## Get the desired results in every application with SAMOA'S RANGE OF AIRLESS SPRAY GUNS

Improve your **performance and productivity** with our PG SERIES Airless Spray Guns. Our **ergonomic** spray guns have been designed to provide an excellent paint transfer rate in every airless application.



### PG350

#### Comfort and durability guaranteed

Main body manufactured in aluminium, sprays at a maximum pressure of 350 bar (5,080 psi).

- 1 Built-in hanger for improved operator usability.
- 2 Robust and durable materials.
- 3 Ergonomic handle to ensure a comfortable fit.

### PG500

#### Your best choice for intensive applications

Main body manufactured in stainless steel, sprays at a maximum pressure of 500 bar (7,250 psi). Ideal for the toughest conditions.

- 4 Robust and durable construction.
- 5 Compatible with anticorrosion coatings.

### PG500 HV

#### The best solution for high viscosity applications

Manufactured in stainless steel, sprays at a maximum pressure of 500 bar (7,250 psi).

- 6 Built-in hanger for improved operator usability.
- 7 Separating the fluid tube from the handle allows the fluid to be heated without affecting the operator's hand.

TECHNICAL DATA	PG350	PG500 / PG500 HV
Max. working pressure	350 bar (5,080 psi)	500 bar (7,250 psi)
Fluid inlet connection	1/4" NPSM (M), swivel connection	1/4" NPSM (M), swivel connection
Spray tip guard connection	7/8"	7/8"
Wetted parts	Aluminium, stainless steel, brass, polyamide, UHMWPE, tungsten carbide	Stainless steel, brass, polyamide, UHMWPE, tungsten carbide
Operation temperature range	+5 °C - 40 °C (+5 °F - 104 °F)	+5 °C - 40 °C (+5 °F - 104 °F)
Max. product temperature	85 °C (185 °F)	85 °C (185 °F)
Filter	100 mesh (30, 60, 200 also available)	100 mesh (30, 60, 200 also available)

- **Paints**
- **Coatings**
- **1k or 2k primers**



# PG SERIES

## ENGINEERED FOR PERFORMANCE

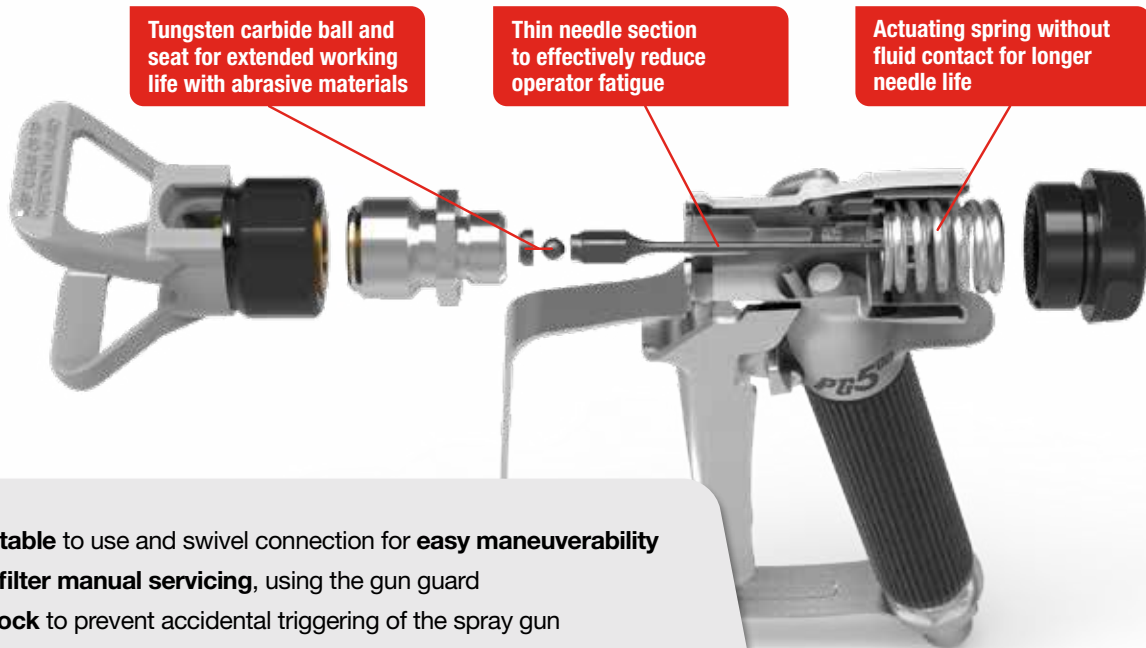

- **Comfortable** to use and swivel connection for **easy maneuverability**
- Internal **filter manual servicing**, using the gun guard
- **Safety lock** to prevent accidental triggering of the spray gun
- Easy assembly and disassembly to **reduce maintenance downtime**
- **Optimized fluid passages** for easy high solid content paint applications

**TIPS AND TIP GUARDS  
COMPATIBLE WITH MAJOR  
COMPETITORS**

### PG SERIES ORDERING INFORMATION

MODEL	TRIGGER	SPRAY TIP GUARD	SPRAY TIP	PART No.
PG350	two-finger			26A211
	two-finger	●		26A251
	two-finger	●	CF350 415	26A241
	four-finger			26B211
	four-finger	●		26B251
	four-finger	●	CF350 415	26B241
PG500	two-finger			26C211
	two-finger	●		26C231
	two-finger	●	CF500 417	26C221
	four-finger			26D211
	four-finger	●		26D231
	four-finger	●	CF500 417	26D221
PG500 HV	four-finger			26F211
	four-finger	●		26F231
	four-finger	●	CF500 421	26F221



**CONTACT US TODAY!**

Visit [www.samoaindustrial.com](http://www.samoaindustrial.com) for more information.

**SAMOA INDUSTRIAL, S.A. - HEADQUARTERS**  
POL. IND. PORCEYO, I-14 - CAMINO DEL FONTÁN, 831  
E-33392 GIJÓN (ASTURIAS), SPAIN  
TEL.: +34 985 381 488

©Copyright, SAMOA INDUSTRIAL, S.A.  
SAMOA Industrial, S.A. is an ISO 9001, ISO 14001 and ISO 45001 certified company.

